

VersaPlanetary Integrated Encoder

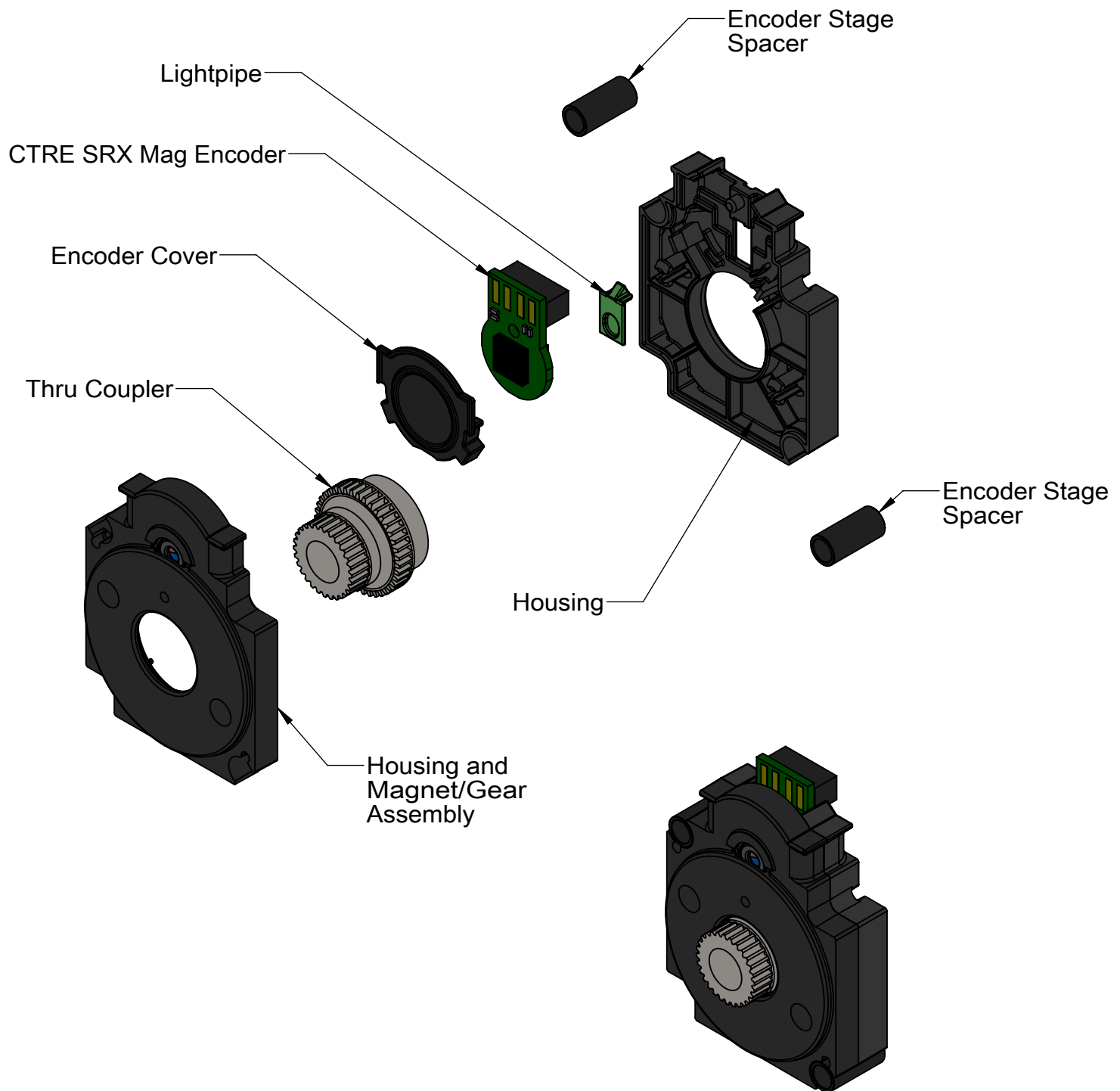

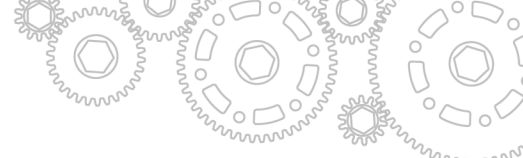

217-5046-Instructions

Step 1:
Insert Lightpipe into pocket on Encoder Housing as shown.

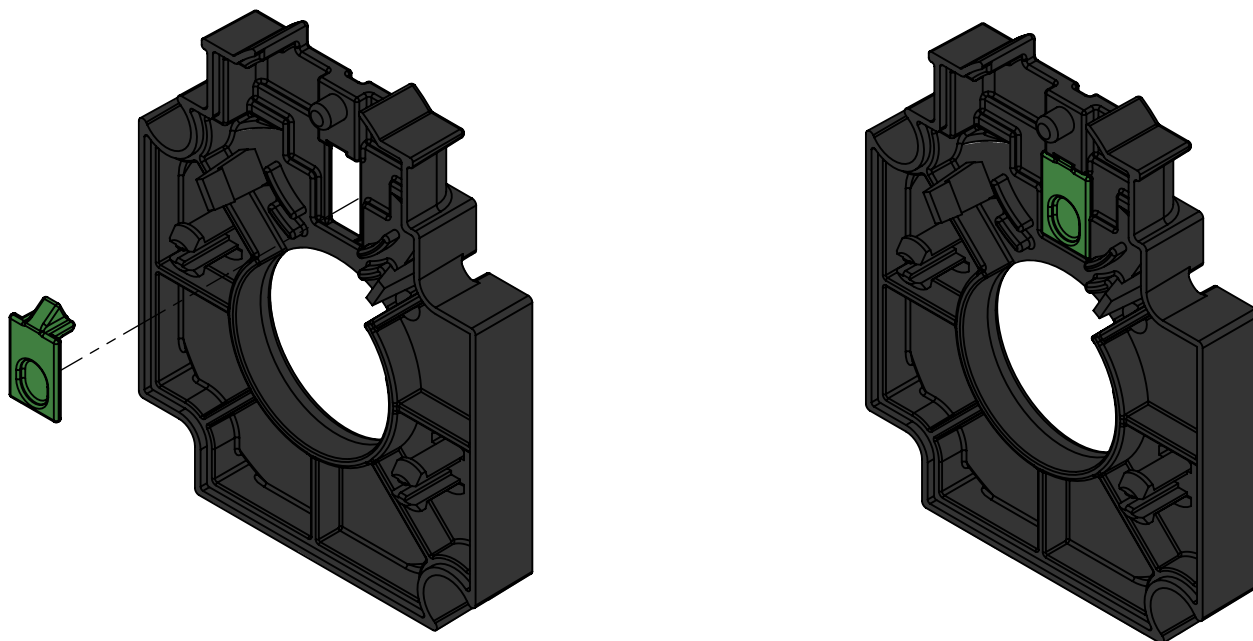

Step 2:
Insert CTRE SRX Mag Encoder, ensure it is fully seated against the plastic housing.

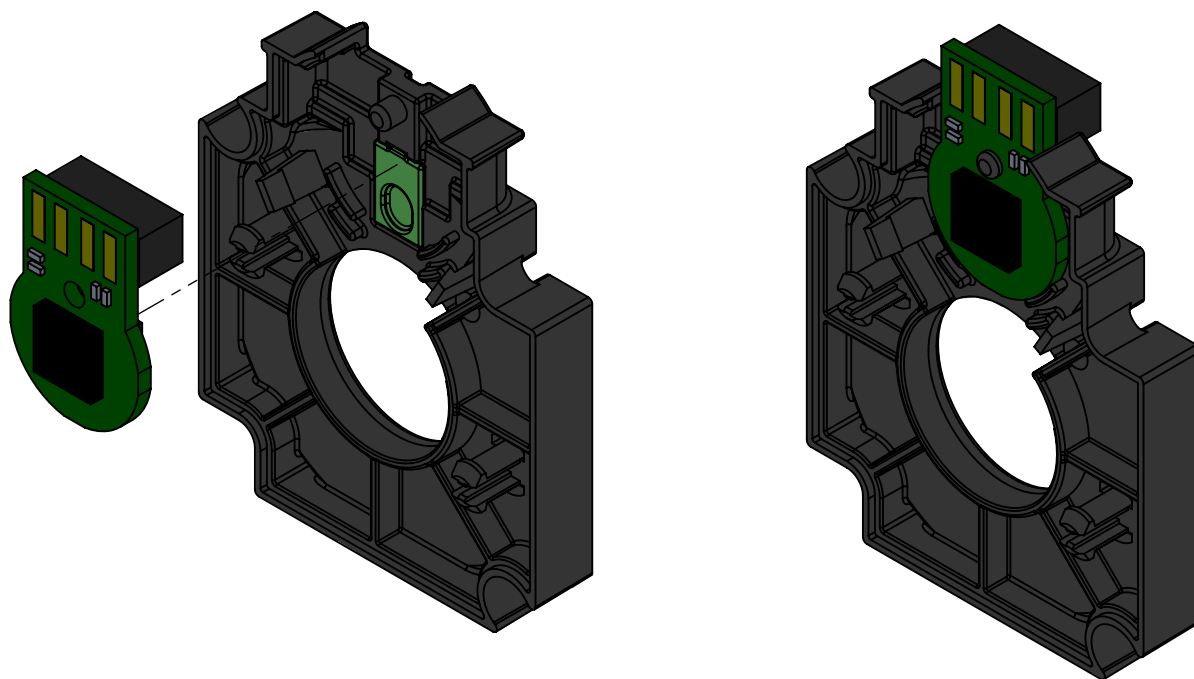

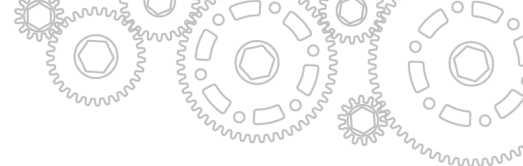

Step 3:
Insert plastic Encoder Cover over the SRX Mag Encoder, cover will latch into place.

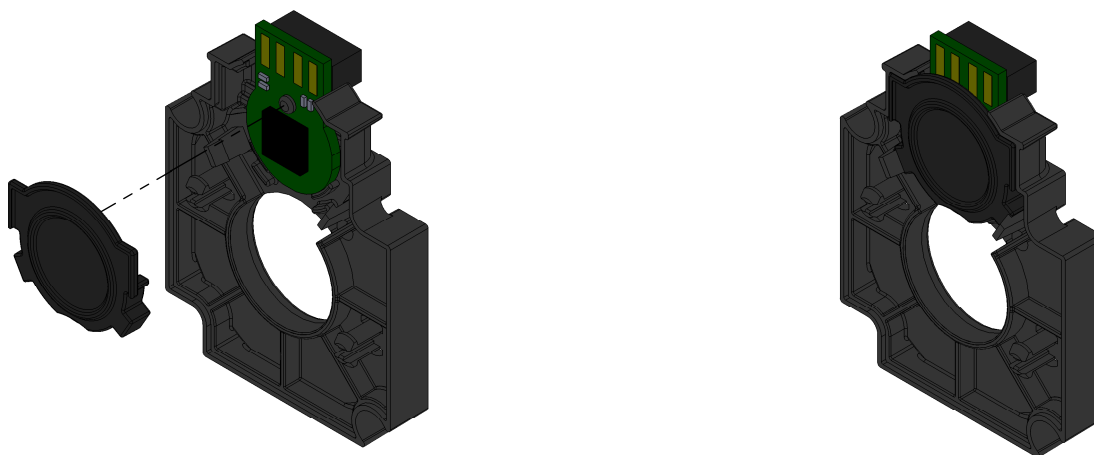

Step 4:
Insert Thru Coupler (Female side first as shown)

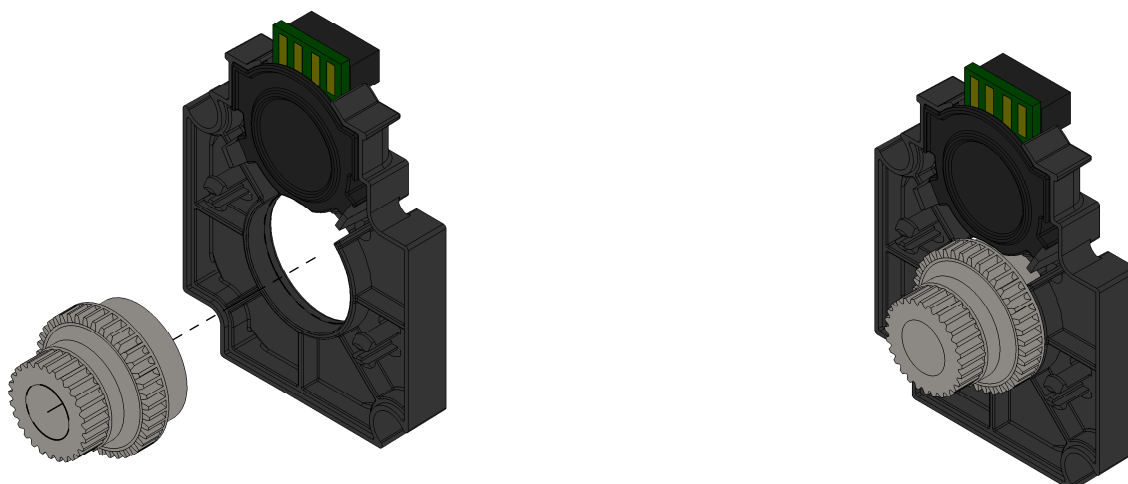



217-5046-Instructions

Step 5:
Snap together plastic housing, be careful to ensure Pre-Assembled gear teeth mesh with Thru Coupling when assembling.
Housing has plastic snaps to hold assembly together.

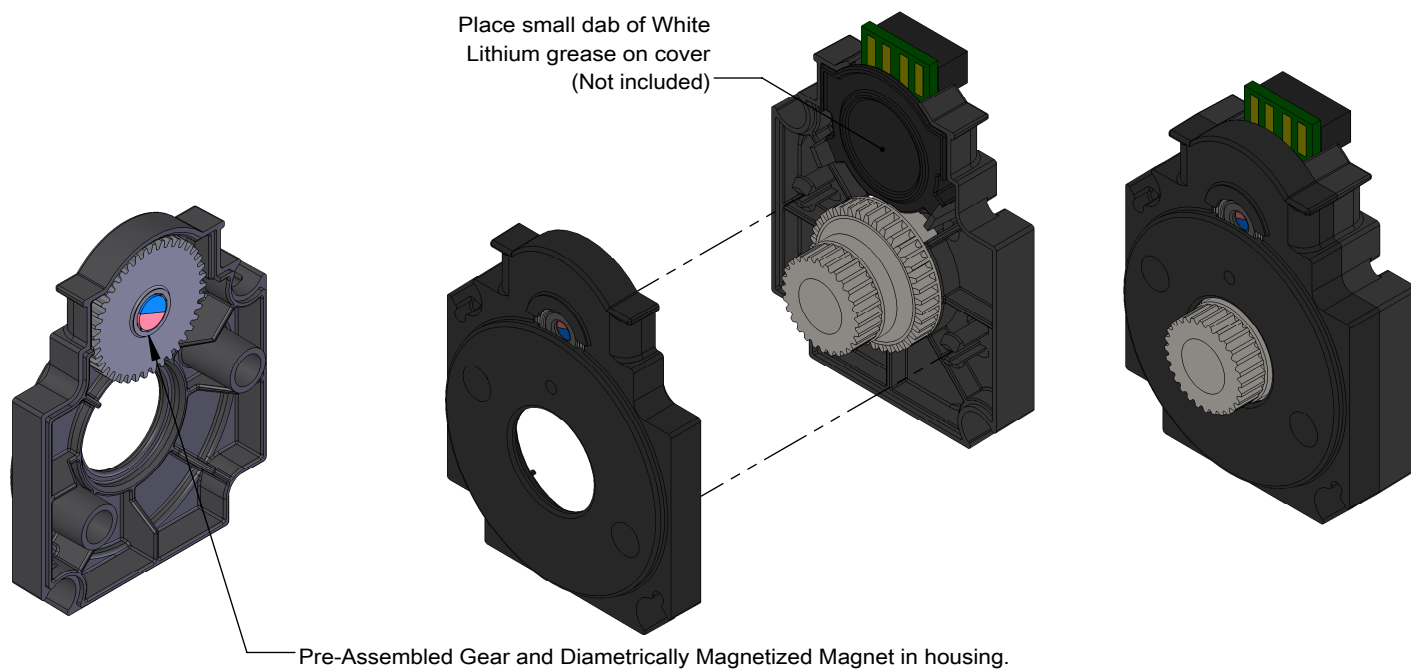

Step 5:
Snap Encoder slice spacers into corner pockets on housing assembly. Encoder stage is now ready to be assembled into a VersaPlanetary.

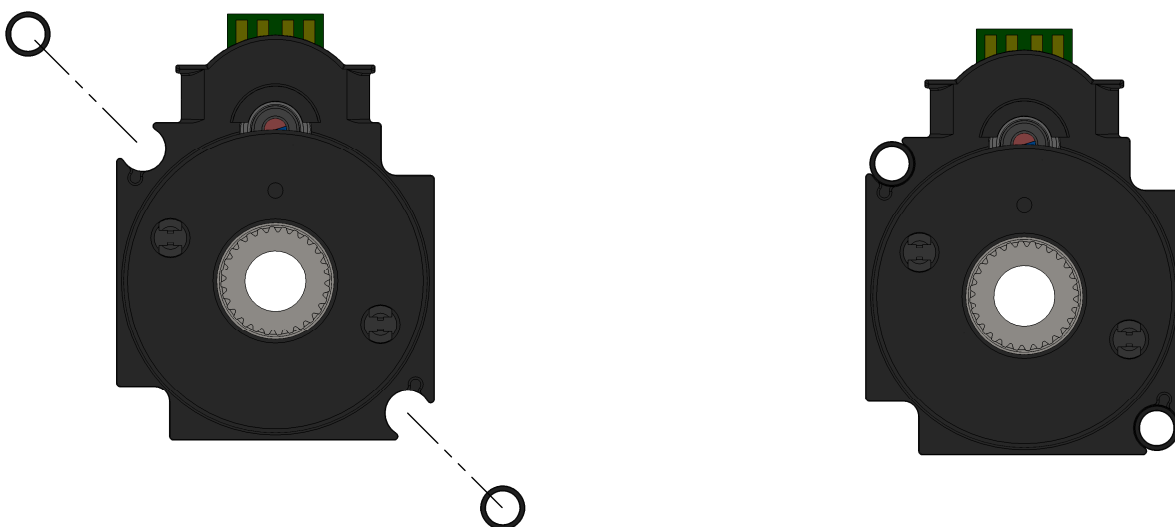

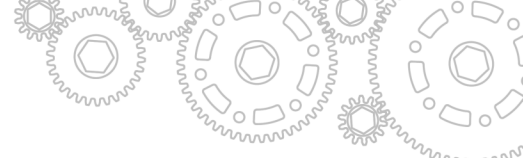

Example 1:1 assembly

